



**Fitzpatrick
Woolmer**

Interpretive Bench

Our **Interpretive Bench** with backrest combines durability, comfort and storytelling in a single design. Crafted from robust FSC and PEFC Oak, it provides a safe, welcoming seating option while its backrest is engraved with bespoke artwork unique to each client's story.

Whether serving as a memorial to a loved one, commemorating a notable individual, or interpreting the local area with maps and illustrations, our Interpretive Bench creates a lasting connection between people and place, offering both function and meaningful expression.

Product features

- * Hardwood FSC and PSFC Oak construction
- * Engraved backrest for added interest
- * Preservative finish
- * Standard size 1800mm wide
- * 1 year manufacturer's warranty

Fitzpatrick Woolmer Design & Publishing Limited

Unit 7 Lakeside Park, Neptune Close, Rochester, Kent, ME2 4LT
t: 01634 711 771 e: info@fwdp.co.uk w: fwdp.co.uk



By Appointment to His Majesty The King
Manufacturer of Signs and Wayfinding
Fitzpatrick Woolmer Design & Publishing Ltd, Kent

Specification applies to the standard product. Our range of options usually allow us to accommodate any differences you may require. Please contact us and we will be happy to support you in developing this specification to meet your requirements.

Manufacturer: Fitzpatrick Woolmer,
Unit 7 Lakeside Park, Neptune Close,
Rochester, Kent, ME2 4LT.
Tel: 01634 711 771
Email: info@fwdp.co.uk

Timber: FSC Prime Grade and PEFC QPA Grade,
generally to BS EN 975-1

Species: Oak

Origin: France

Moisture content on delivery: 10% - 80%

Finish: Sadolin Classic wood preservative,
solvent based, matt

Colour: Light Oak

Weight: 187kg

Installation: Posts extend 600mm below ground level

Guarantee: One year manufacturer's warranty

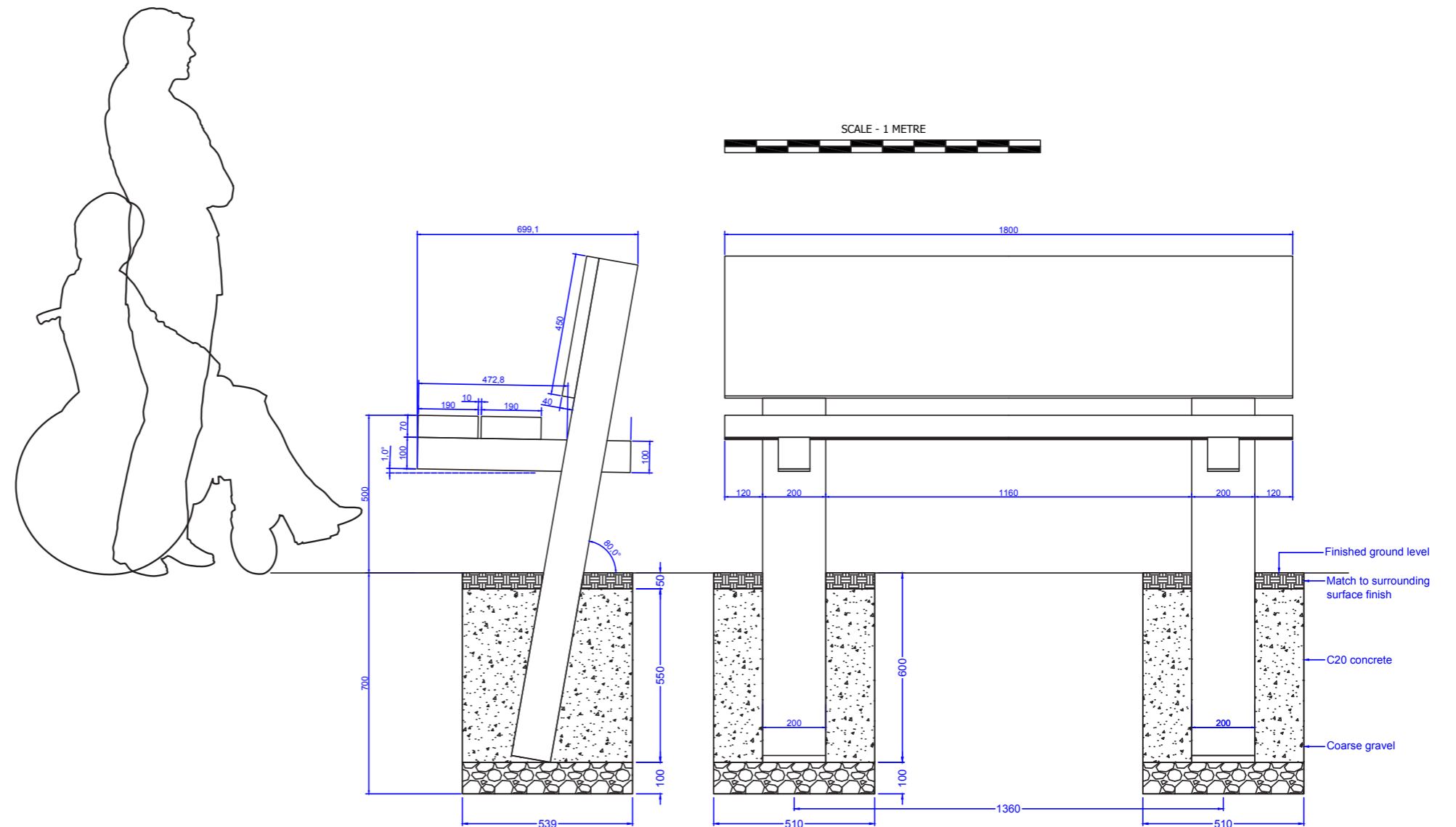

Note: All dimensions are indicative only. Footing details are subject to soil conditions and structural engineers recommendations.